

## Mounting instructions for EAF motor mounting kit on Samyang 135mm F2 lens



### Scope of delivery:



- |   |                                     |
|---|-------------------------------------|
| 1) Front pipe clamp                     | 7) 2x Connecting piece (1x Reserve) |
| 2) Rear pipe clamp                      | 8) M4x12                            |
| 3) Prism rail bottom                    | 9) M5x16                            |
| 4) Top rail                             | 10) M5x22                           |
| 5) Motor attachment and GT2 timing belt | 11) M5x14                           |
| 6) Toothed belt mount                   | 12) Washers                         |

**Parts 1 and 2 are already pre-assembled. Here, 2x M5 washers are also fitted to prevent the pipe clamps from being overtightened. These serve as resistance and must be reinserted before screwing.**

**Mounting accessories are not included in the scope of delivery (Allen key size 4 and 5)**

Please always bear this in mind with 3D printed parts! After tight comes off!

Tighten the parts carefully so that a firm resistance can be felt at.

Do not go beyond this.

Work step 1:

Slide the front clamp (2) to the end of the lens and tighten it using the screw (9 – already pre-installed, must be loosened before starting this step).der Rohrschelle.



Work step 2:

Place the belt mount (6) as shown at the marked position and secure it using the connector piece (7).

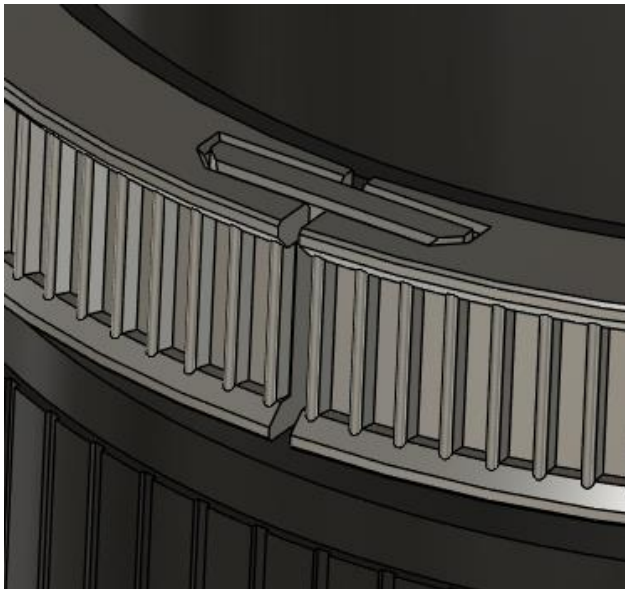
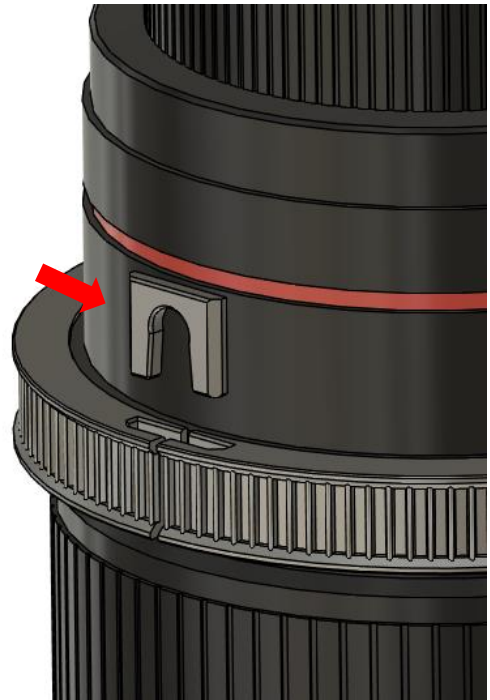
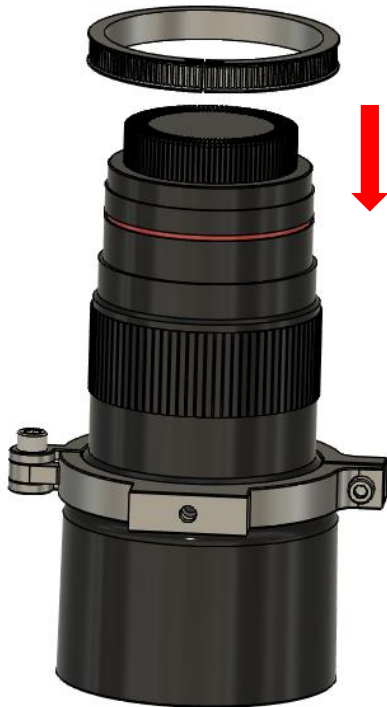

Work step 3:

Place the GT2 belt (5) over the Samyang lens, then mount the rear clamp (3) and tighten it as shown.

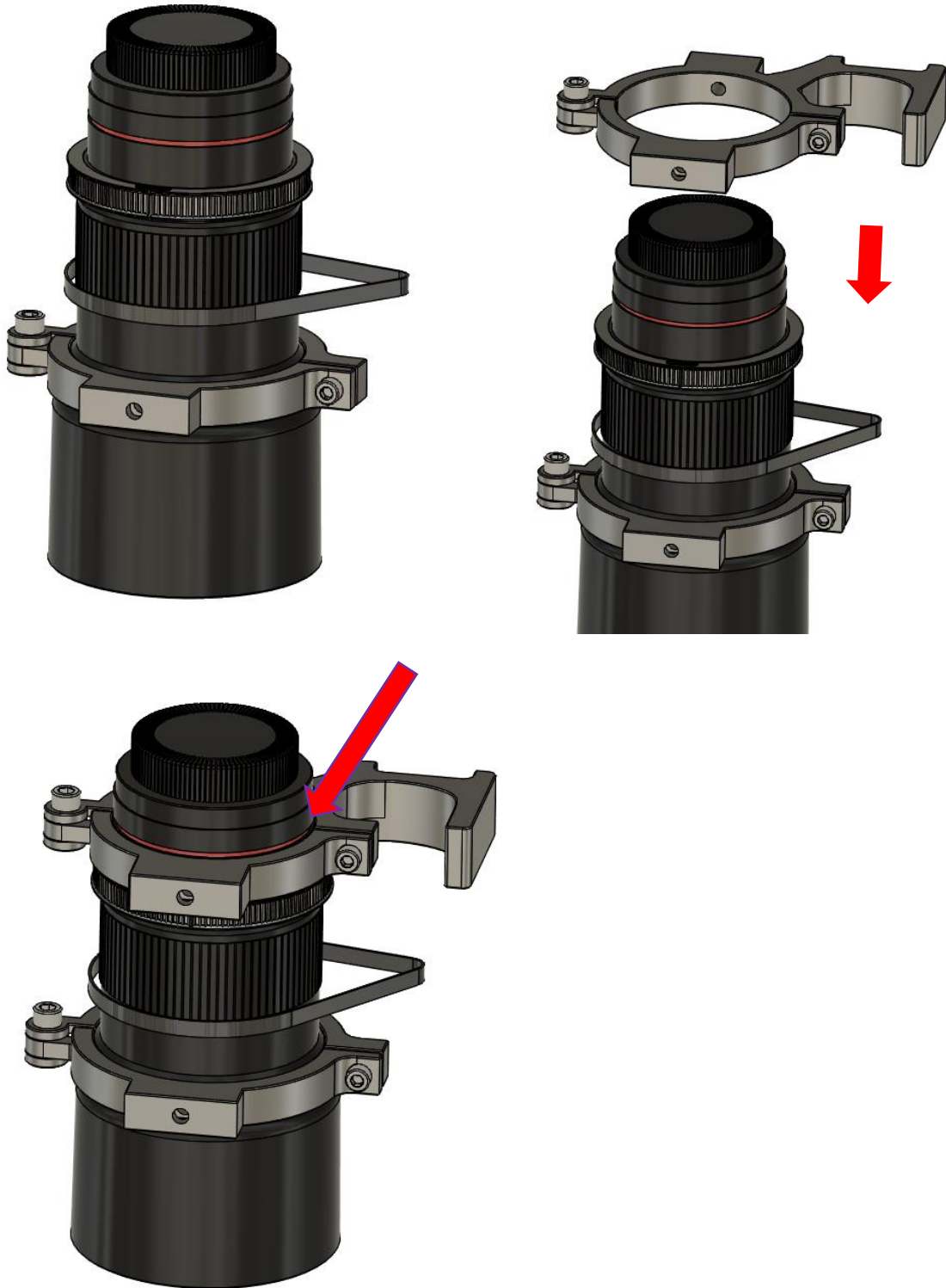

Work step 4:

Place two washers (12) over the two M5x22 screws (10) and attach the bottom dovetail plate (3) the clamps.

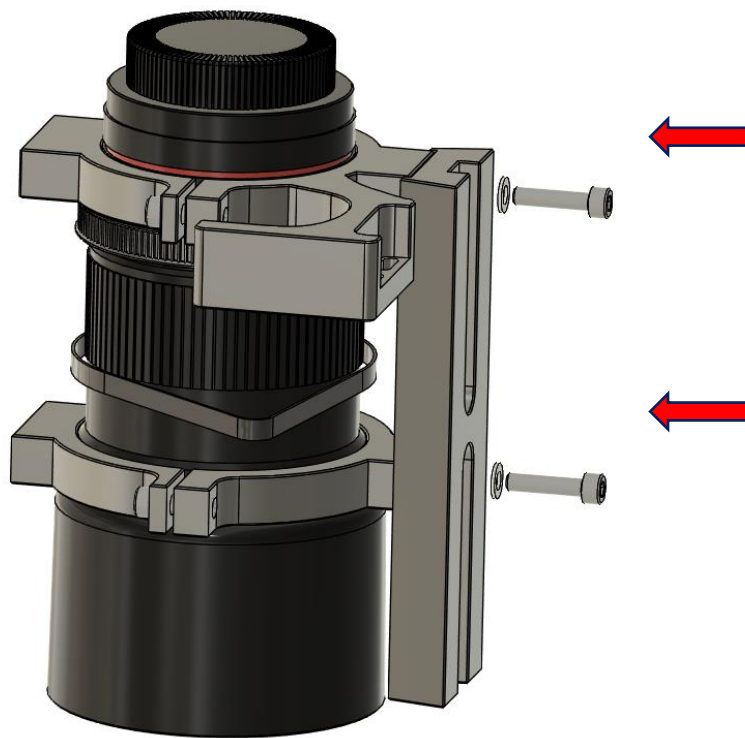



Work step 5:

Attach the top plate (4) using the included M5x14 screws (11).

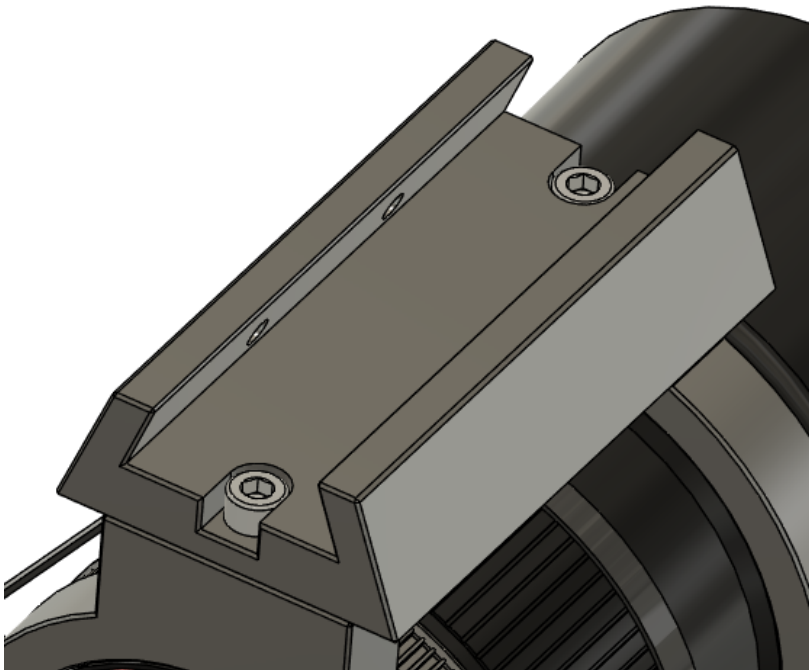
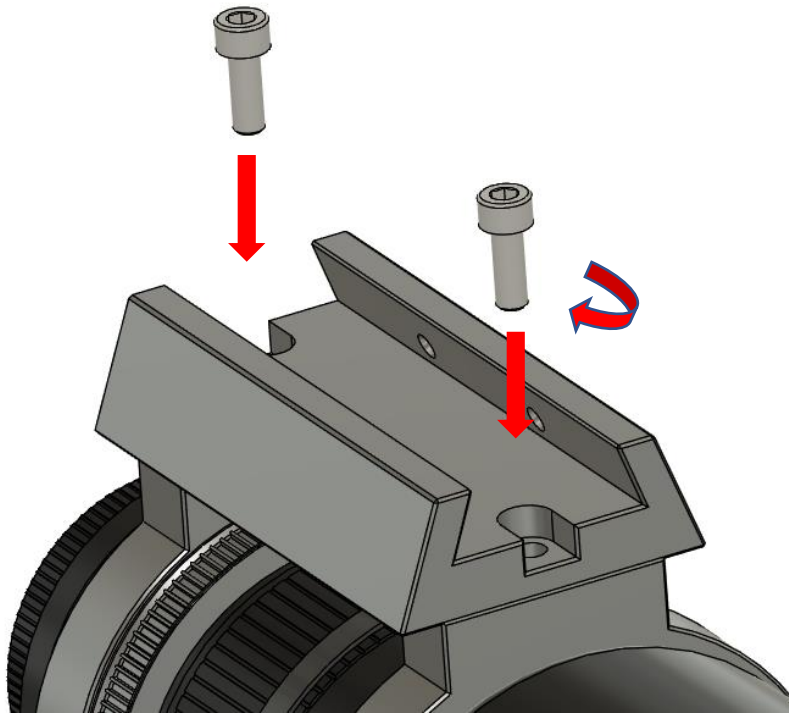

Work step 6:

Screw the motor mount (7) to the ZWO EAF motor as shown. Leave a small gap between the motor mount and the motor housing to avoid friction.

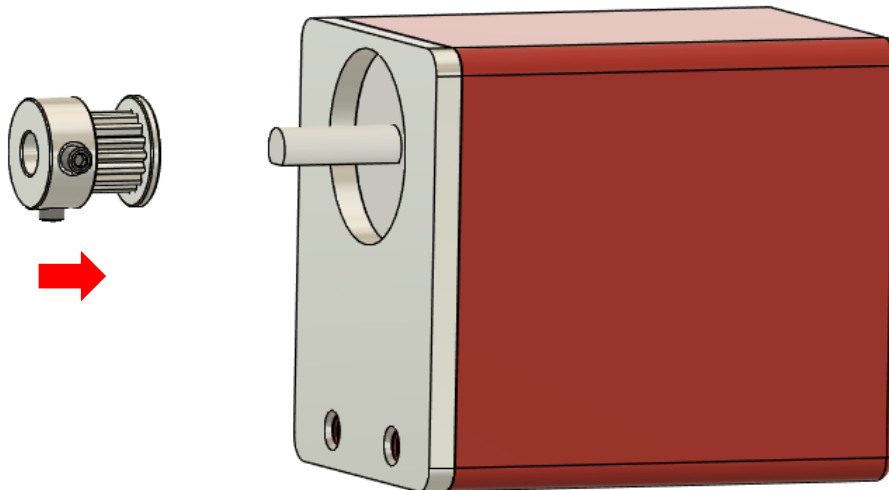



Work step 7:

Insert the ZWO EAF motor between the two clamps and place the GT2 belt over the motor pulley. Make sure the ring sits correctly in the belt mount.

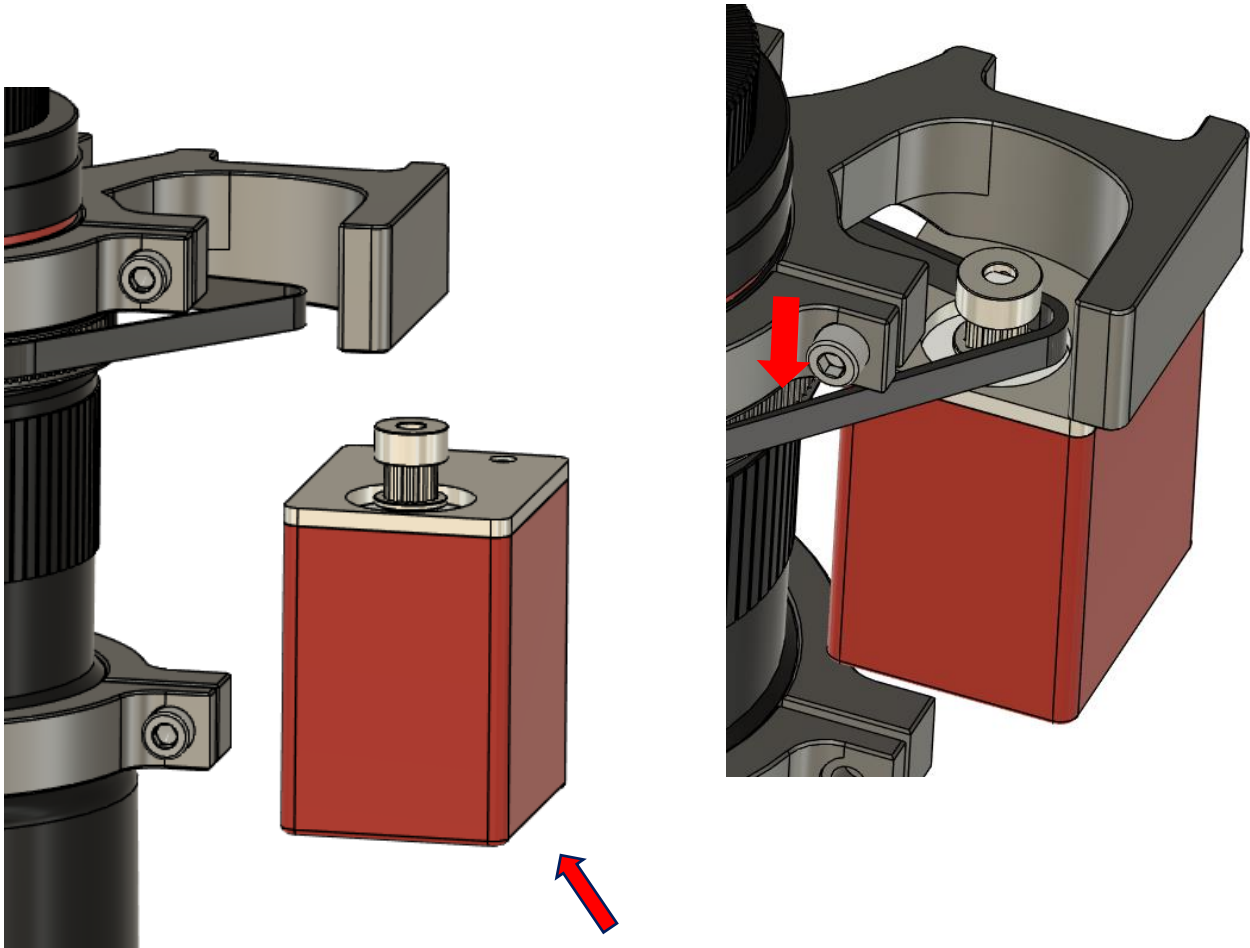

Work step 8:

Use the two M4x12 screws (8) as shown in the images and loosely attach the ZWO EAF motor to the motor bracket on the clamp. Double-check that the belt is seated properly in the mount and around the pulley.

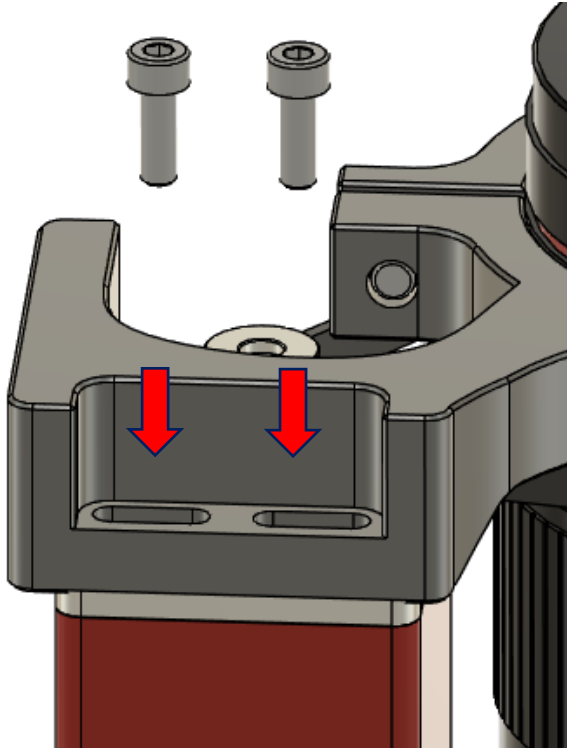

Work step 9:

Slide the ZWO EAF motor until the GT2 belt is taut, then tighten the two M4x12 screws.

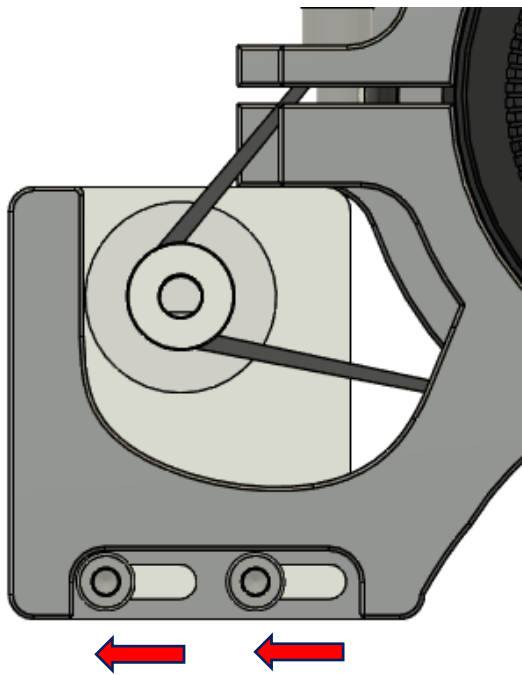
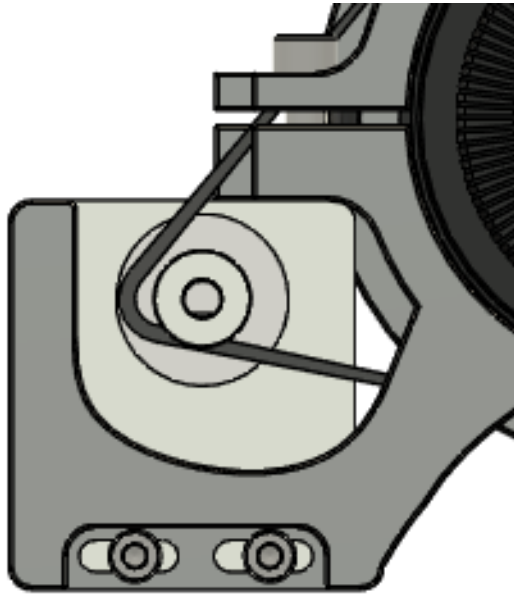

Your setup should now look like the reference image, and your ZWO motor adaptation for the Samyang 135mm F2 lens is complete.

